

DETAIL OF ROAD-SIDE LOTS BLOCK C AS SUBD. IN FIELD PRIOR TO 1957
12/7/55 J.H.

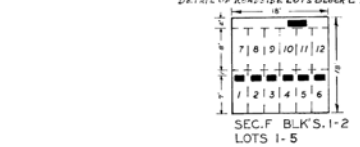

SEC. F BLK'S. 1-2
LOTS 1-5

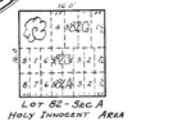

HOLY INNOCENT AREA
NOTE: GRAVES IN 8240 ARE TYPICAL SIZE. GRAVES IN 8240 ARE 10' X 10'. OTHER GRAVE SIZES.



NO MONUMENT LOT

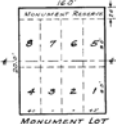

MONUMENT LOT

TYPICAL LOT LAYOUTS
OLD SUBDIVISION
SECTIONS A, B, C, D, E & G



MONUMENT LOT

TYPICAL LOT LAYOUTS
NEW SUBDIVISION
BLOCKS 3-10 INCL.

NOTE:
New Subdivision is With
Dark Out Line
Blocks 3-10 Inclusive

NOTE:
The numbering of
individual graves in this
plan begins in the N.E. corner
and continues in consecutive
order as shown

NOTE: 4" DRAIN TILE INSTALLED 5-7-76

**ST. MARY CEMETERY
LAKE FOREST — ILLINOIS**

**ENTIRE SUBDIVISION PLAN
1885**

REVISED DESIGN BY
ORIGINAL SURVEY BY
RESURVEYED BY
PLATTED BY
APPROVED BY
FINAL CHECK BY
HILLSIDE, ILLINOIS
COPY MOUNTED

G. GARCEAU & R. REEDY
JAMES ANDERSON CO., INC.
R. J. MARREDO
R. J. MARREDO
D. J. MARREDO
DECEMBER, 1967
JANUARY 23, 1885

0 10 20 30 40 50 60 70
653 ACRES

N

SCALE 1" = 30'